

VELDEN LX

OPEN ISLANDS & SEMI-VERTICAL • REMOTE REFRIGERATION UNIT



T/03/2023 content modifiable without notice.

VELDEN LX ISL-A-2 TN V LINEARE R

Length without side panels	mm		1250	1875	2500	3750	
Temperature class		3 M1	•	•	•	•	
		3 M2	•	•	•	•	
Preservation temperature	°C	0/+2	•	•	•	•	
		+2/+4	•	•	•	•	
Horizontal display area*	m ²	Depth	130	1,2	1,8	2,4	3,6
			140	1,38	2,06	2,75	4,13
			160	1,6	2,4	3,2	4,8
			180	1,88	2,81	3,75	5,63
			194	2,03	3,04	4,05	6,08
Energy class**		Depth 130-140 -160-180 -194					

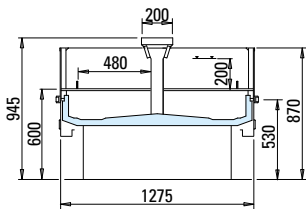

130

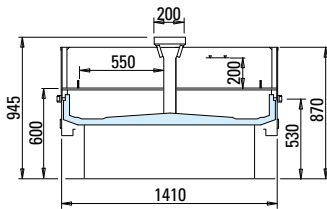

140

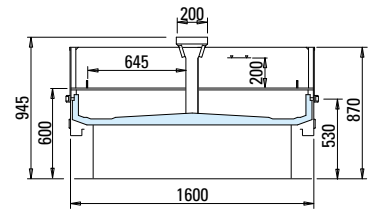

160

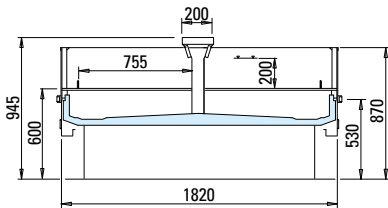

180

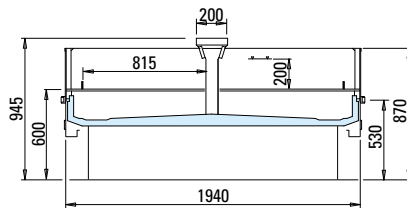

194

VELDEN LX ISL-A-2 TN V TESTATA R

Overall length	mm		1284	1419	1610	1832	1952
Temperature class		3 M1	•	•	•	•	•
		3 M2	•	•	•	•	•
Preservation temperature	°C	0/+2	•	•	•	•	•
		+2/+4	•	•	•	•	
Horizontal display area*	m ²		0,77	0,86	0,99	1,13	1,21
Energy class**							

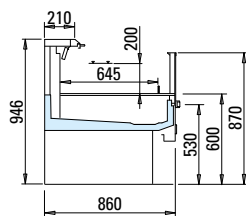
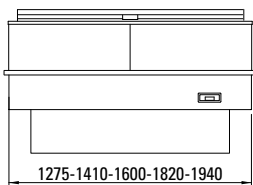

130

*Value referred to illustrated configurations.

**The energy class may vary depending on the product configuration.

VELDEN LX SVT-A-2 TN V LINEARE R

Length without side panels	mm	1250			1875				2500				3750								
		125	135	140	150	125	135	140	150	125	135	140	150	125	135	140	150				
Height	cm																				
Temperature class	3M1	•	•	•	•	•	•	•	•	•	•	•	•	•	•	•	•				
	3M2	•	•	•	•	•	•	•	•	•	•	•	•	•	•	•	•				
Preservation temperature	°C																				
	0/+2	•	•	•	•	•	•	•	•	•	•	•	•	•	•	•	•				
+2/+4	•	•	•	•	•	•	•	•	•	•	•	•	•	•	•	•	•				
Horizontal display area*	m ²	Depth	130	-		2,58	2,93	3,86	-	3,86	3,9	5,15	-	5,15	5,85	7,73	-	7,73			
			140	-			3,19		4,13		4,25		5,5		6,38		8,25				
			160	2,6		3,35		3,9		5,03		5,2		6,7		7,8		10,05			
			180	-				4,31	5,44	-	5,44	5,75	7,25	-	7,25	8,63	10,88	-	10,88		
			194	3,28		-		4,91		6,41		6,55		8,55		9,83		12,83			
Energy class**	Depth	130	-			A>G F	A>G F	-	A>G F	A>G F	-	A>G F	A>G F	-	A>G F	A>G F	-	A>G F			
		140	-				A>G F			A>G F		A>G F		A>G F		A>G F		A>G F			
		160	A>G F				A>G F			A>G F		A>G F		A>G F		A>G F		A>G F			
		180	-				A>G F		-	A>G F	A>G F		-	A>G F	A>G F		-	A>G F			
		194	A>G F		-		A>G F			A>G F		A>G F		A>G F		A>G F		A>G F			

*Value referred to illustrated configurations.

**The energy class may vary depending on the product configuration.

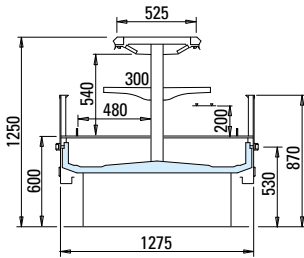

130 H125

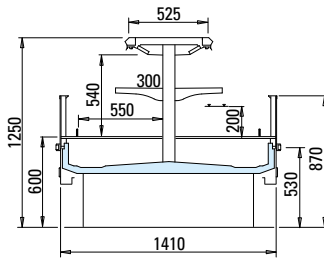

140 H125

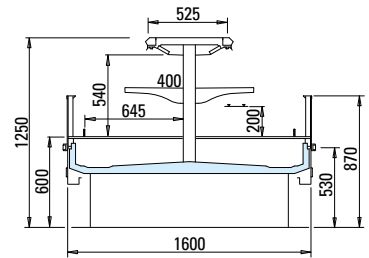

160 H125

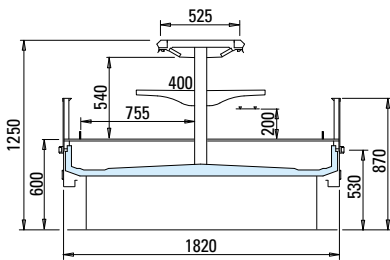

180 H125

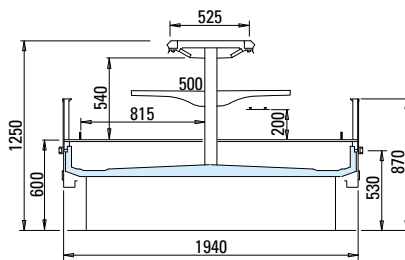

194 H125

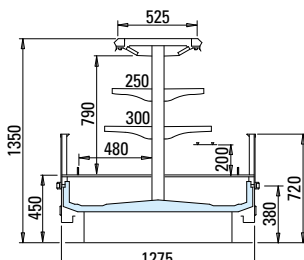

130 H135

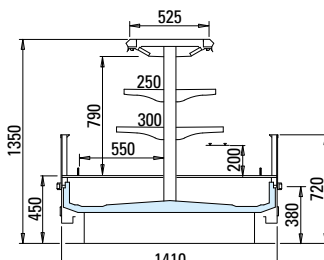

140 H135

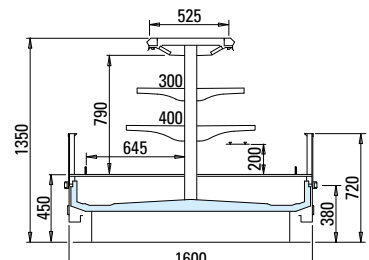

160 H135

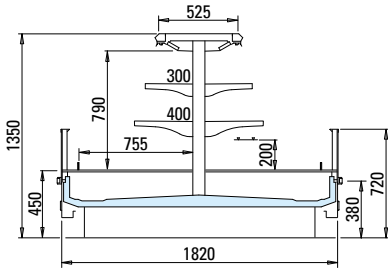

180 H135

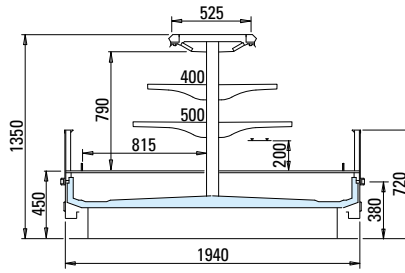

194 H135

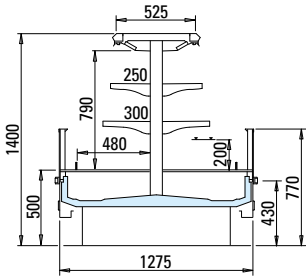

130 H140

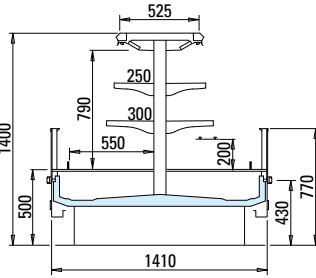

140 H140

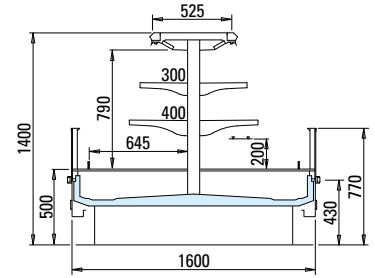

160 H140

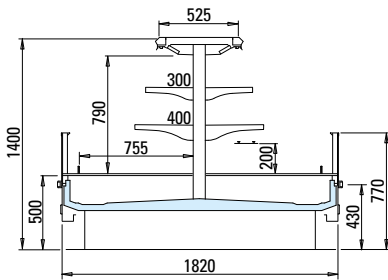

180 H140

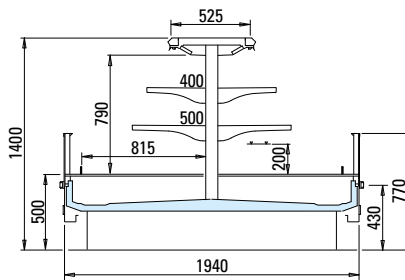

194 H140

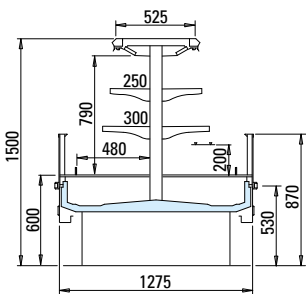

130 H150

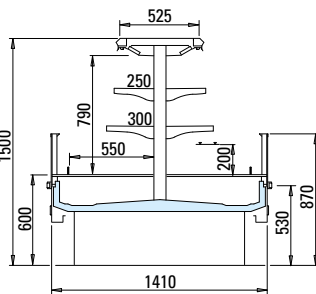

140 H150

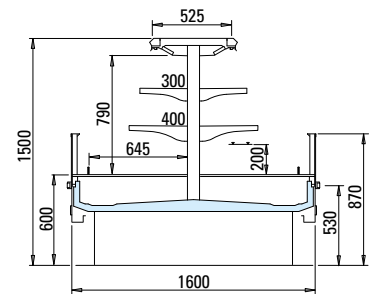

160 H150

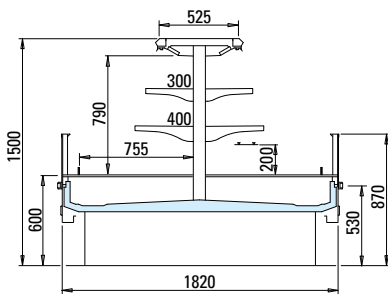

180 H150

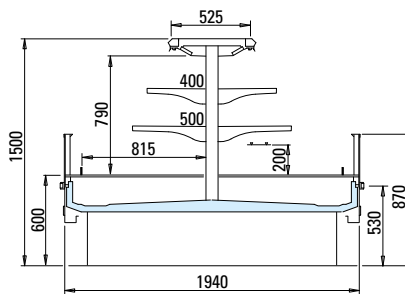

194 H150

VELDEN LX SVT-A-2 TN V TESTATA R

Overall length	mm	1284				1419				1610				1832			1952			
		125	135	140	150	125	135	140	150	125	135	140	150	125	135	150	125	135	140	150
Height	cm																			
Temperature class	3 M1	•				•				•				•			•			
	3 M2	•				•				•				•			•			
Preservation temperature	°C																			
	0/+2	•				•				•				•			•			
+2/+4	•	•				•				•				•			•			
Horizontal display area*	m ²	1,24	1,59			1,38	1,77			1,58	2,03			1,82	2,33		1,95	2,5		
Energy class**		A-G F				A-G F				A-G F				A-G F			A-G F			

*Value referred to illustrated configurations.

**The energy class may vary depending on the product configuration.

